

END OF EXTRUSION
OVER THE GEAR ASSEMBLY

FLAT LIP OF
DRIVE GEAR

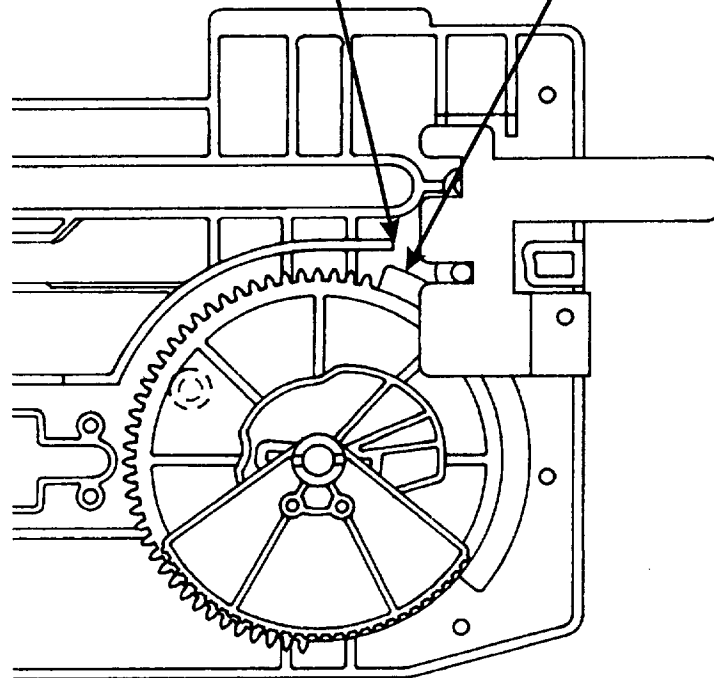

DETAIL A

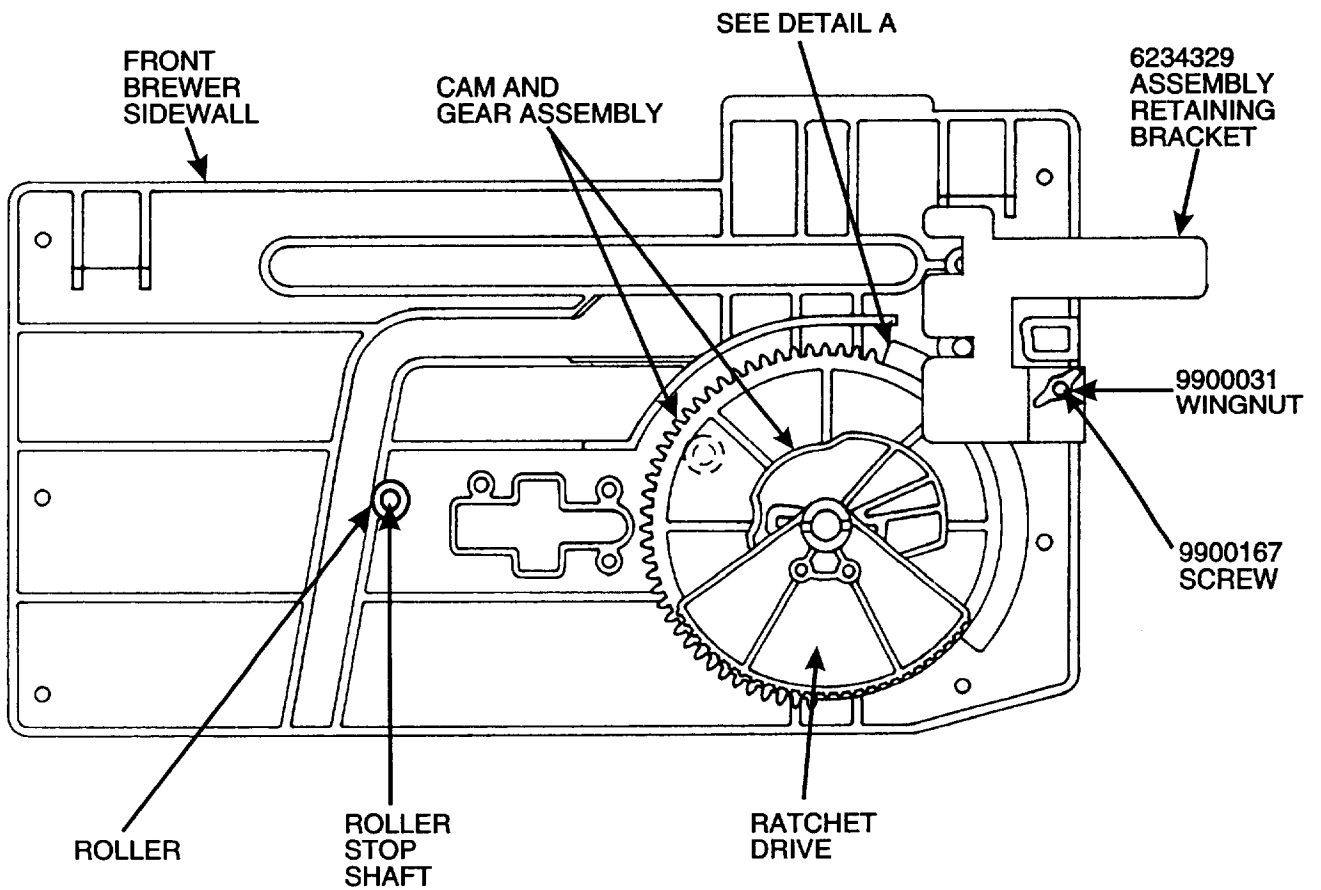

FIG. 1

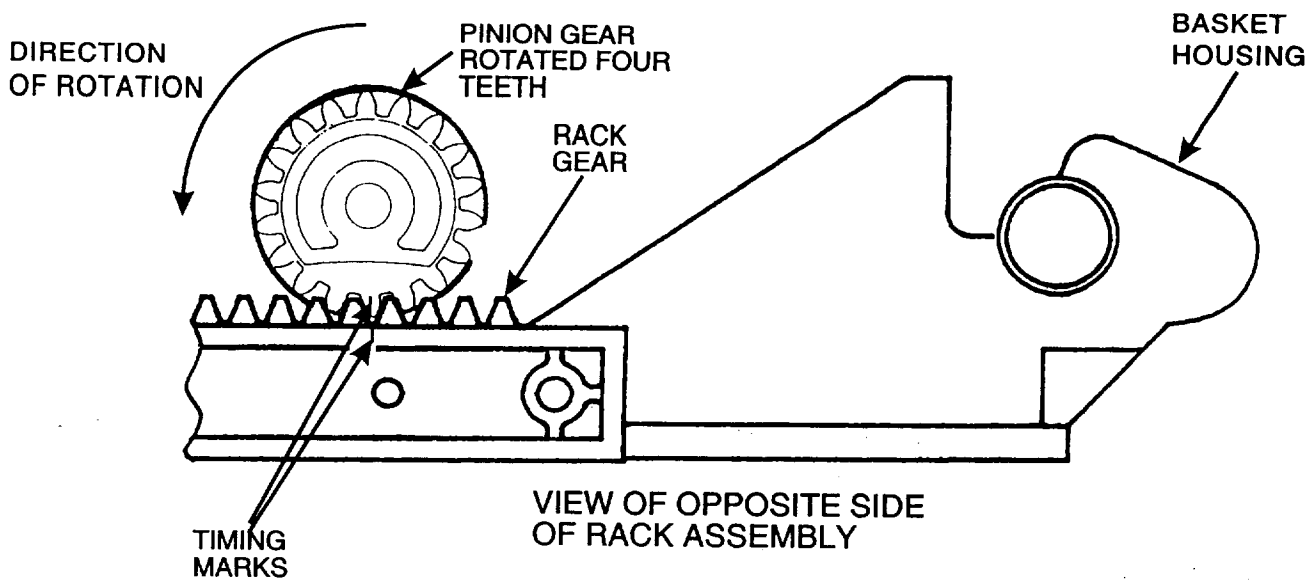
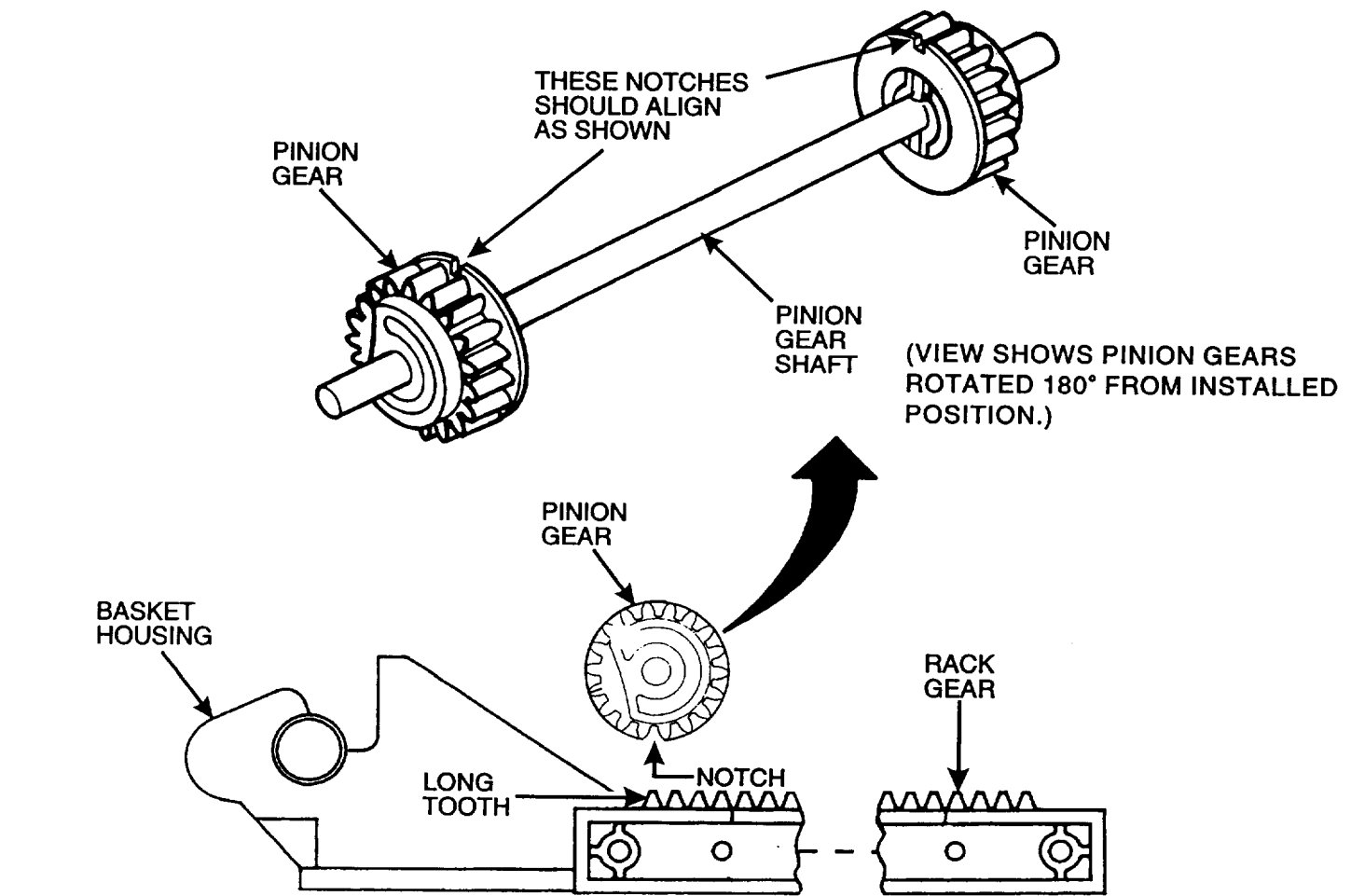

FIG. 2

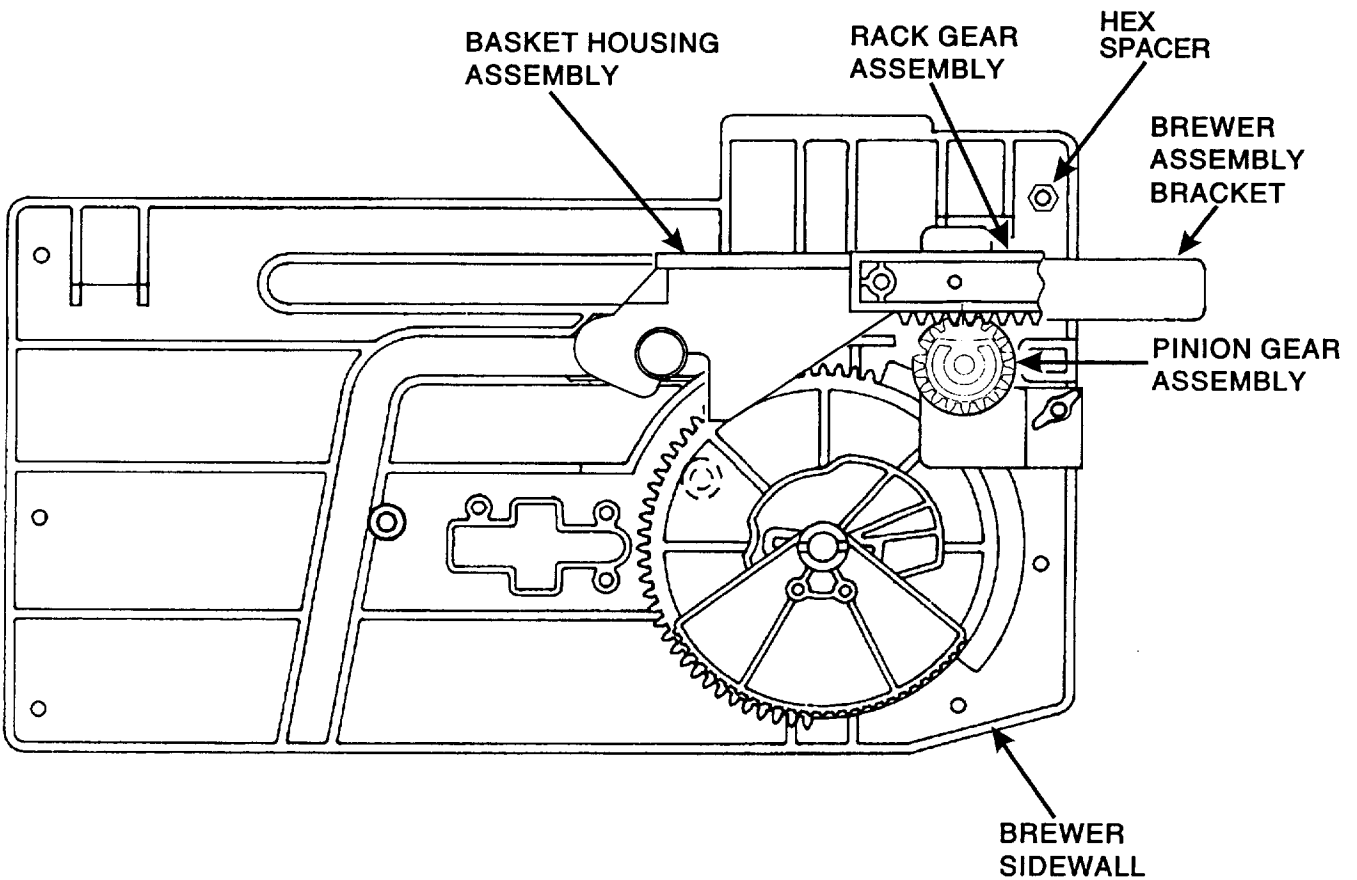
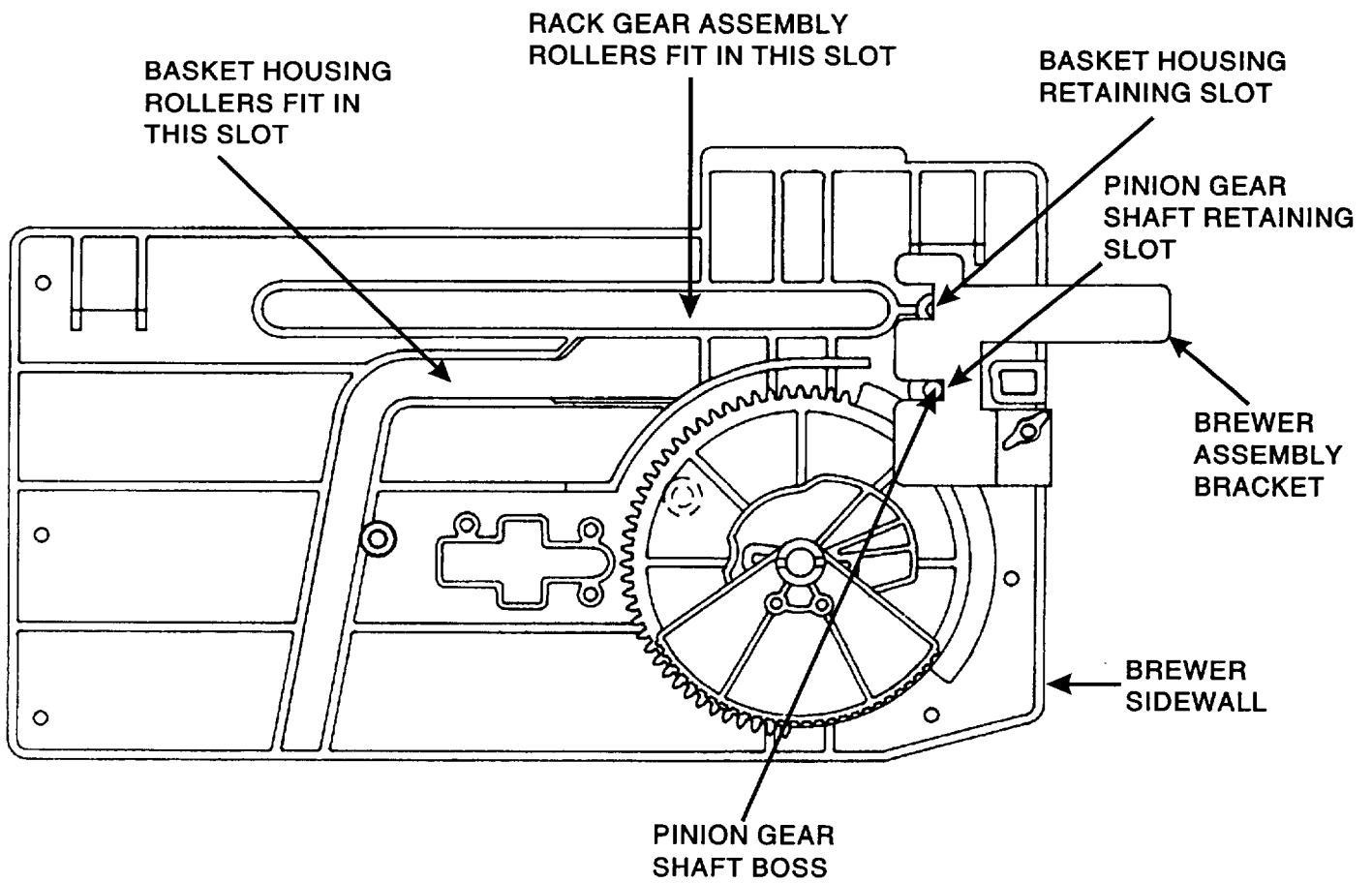

FIG. 3

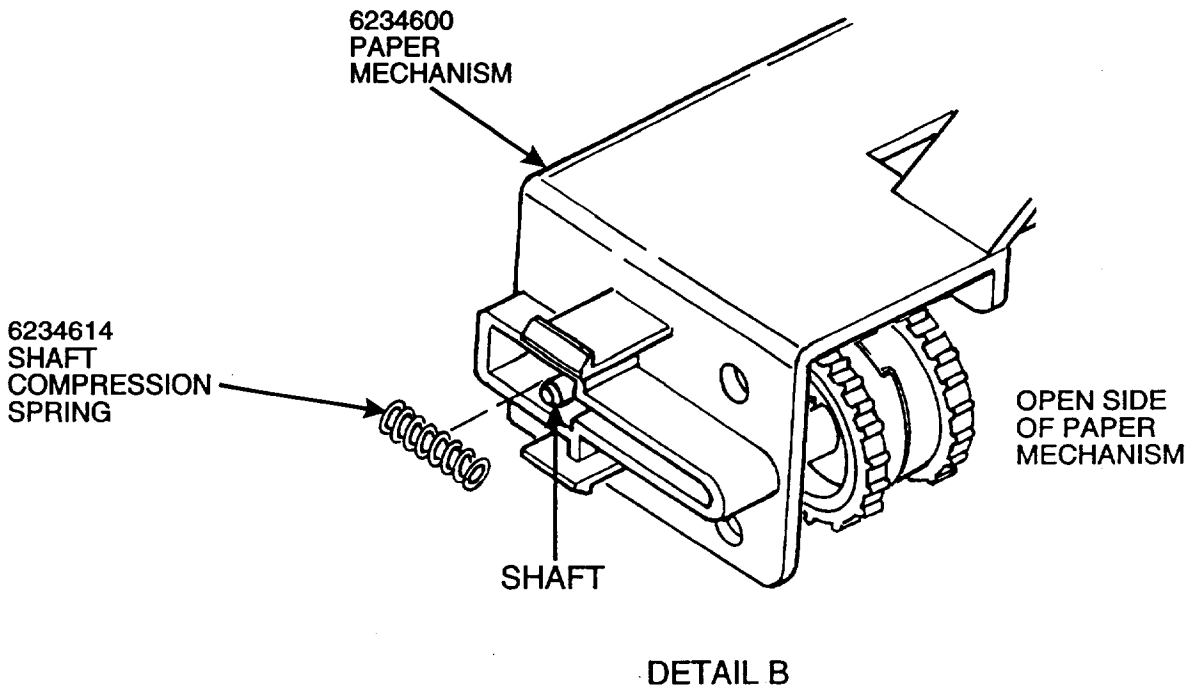
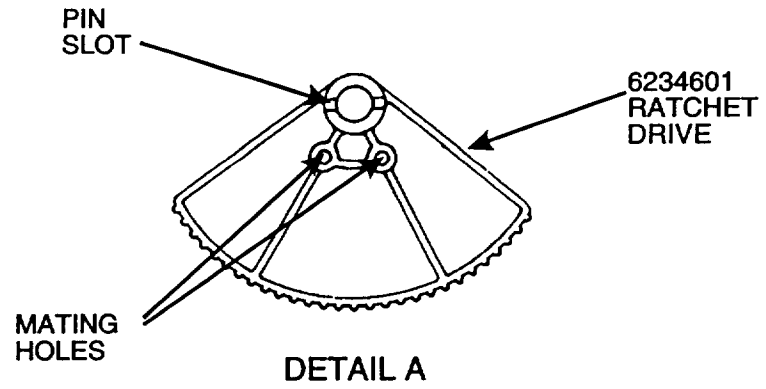

Figure 4.

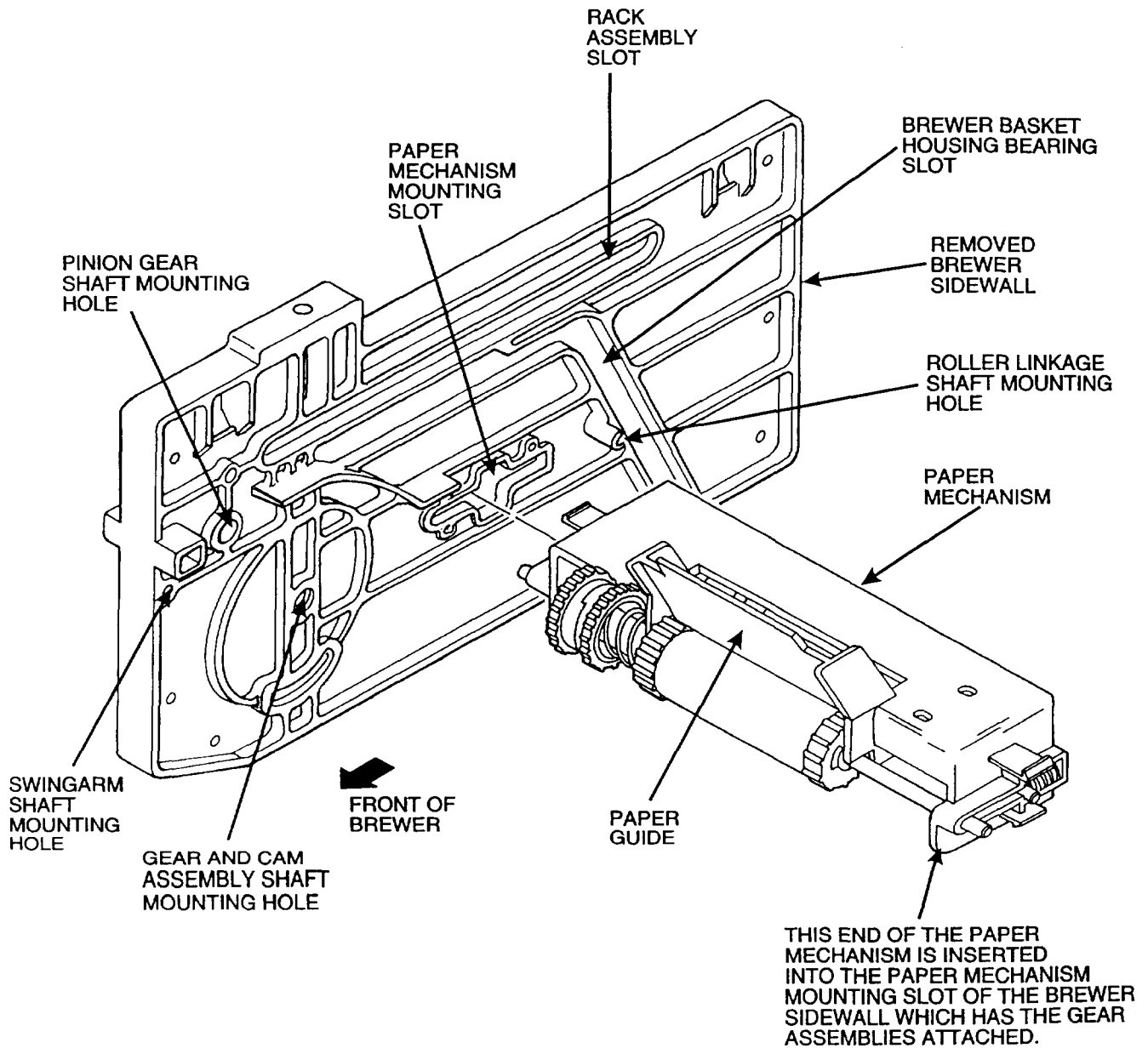
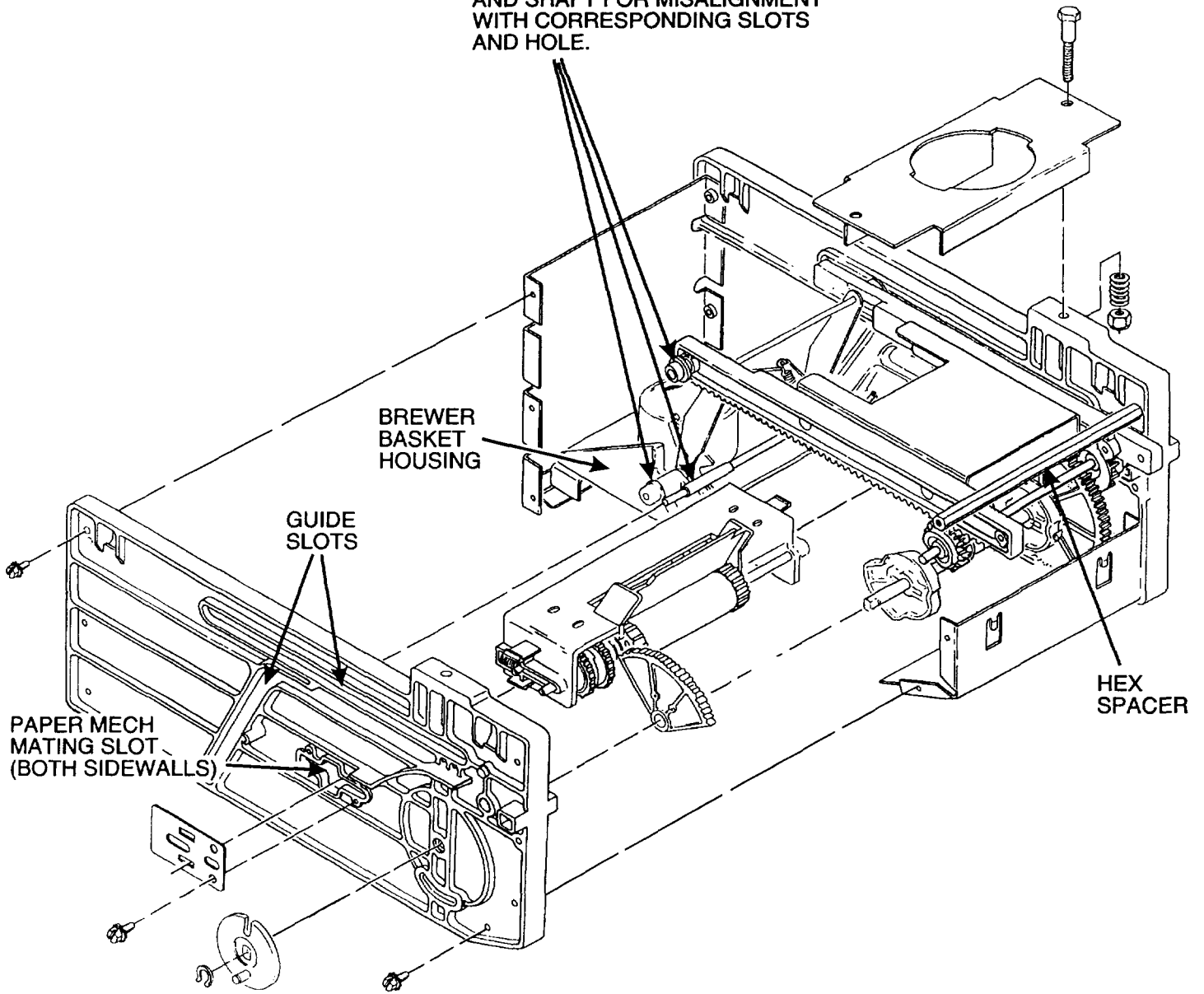

Figure 5.

IF THE SIDEWALL DOES NOT SEAT
READILY DURING ASSEMBLY,
CHECK THESE ROLLER BEARINGS
AND SHAFT FOR MISALIGNMENT
WITH CORRESPONDING SLOTS
AND HOLE.



NOTE
BREWER SHOWN IN THE
FLIP POSITION.

Figure 4.1.1.1

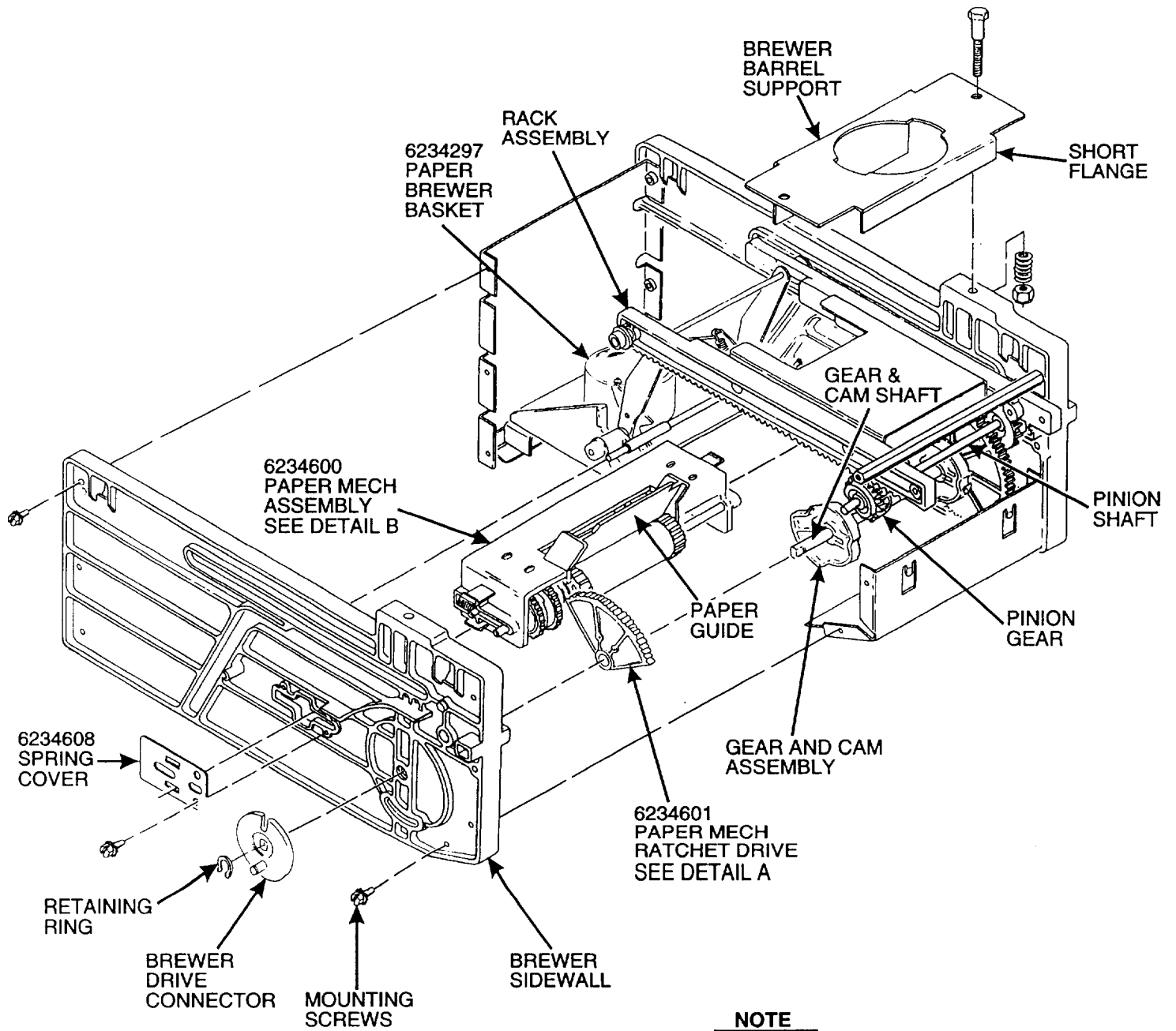

NOTE
 BREWER SHOWN IN THE
 FLIP POSITION.

Figure 4-10-1

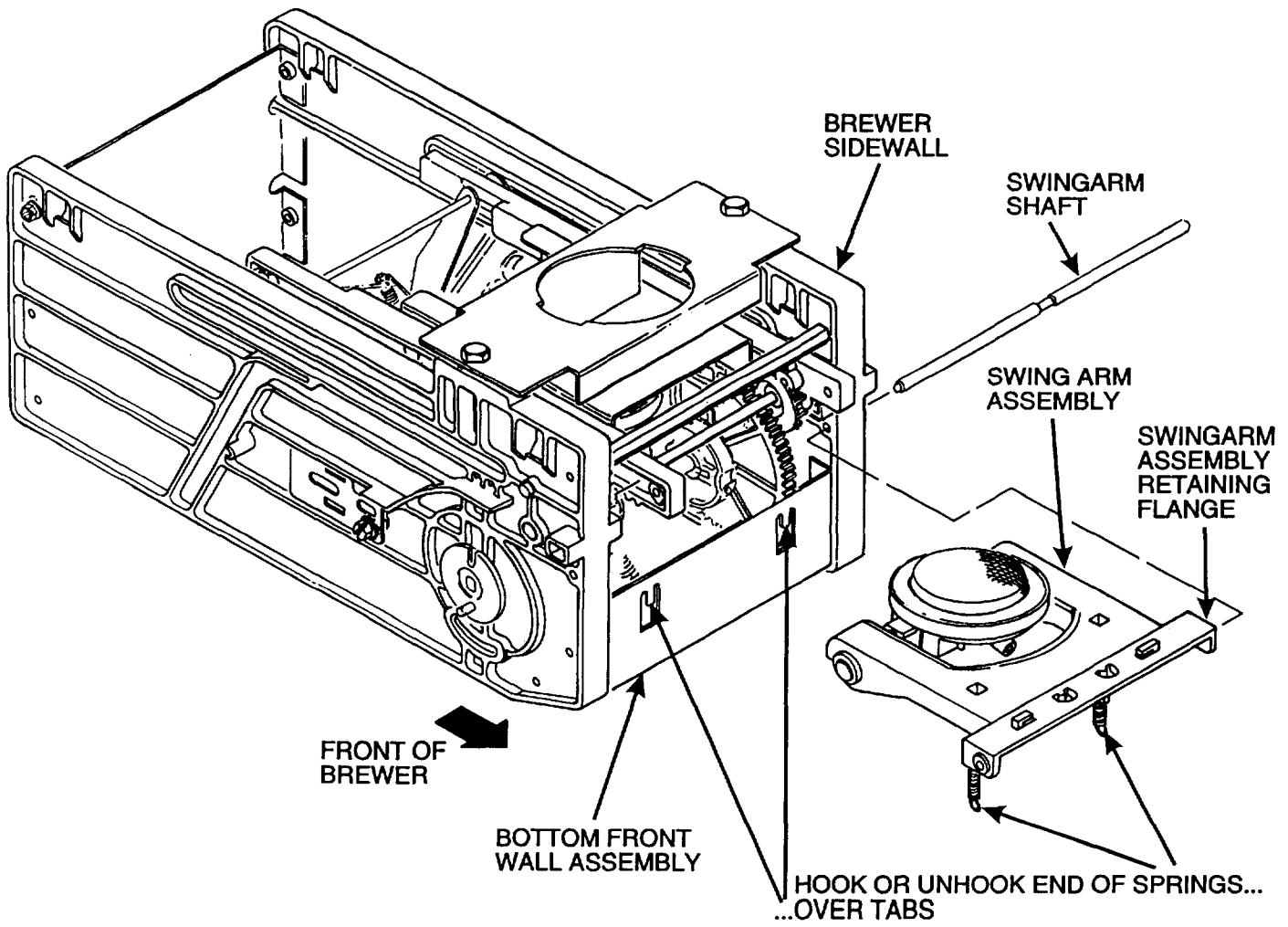

Figure

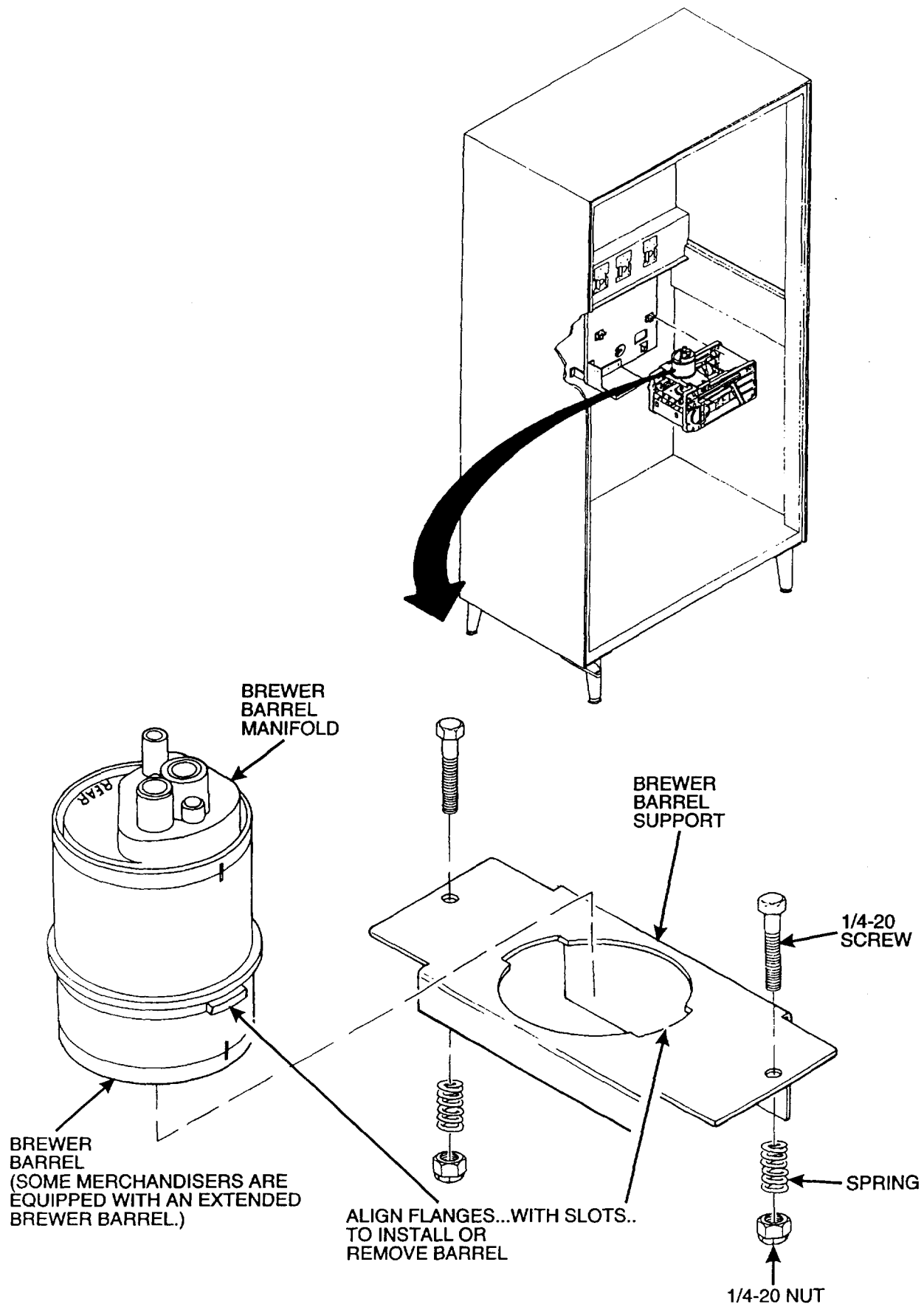

Figure 2.

KIT PART NUMBER 6234331

INSTRUCTIONS FOR INSTALLING A PAPER MECHANISM KIT

**CHECK THE PARTS RECEIVED IN THE KIT WITH THE PARTS LIST
IN THESE INSTRUCTIONS. IF ANY PARTS ARE MISSING,
CONTACT NATIONAL VENDORS' PARTS DEPARTMENT IMMEDIATELY.**

Read these instructions carefully before installing the kit.
Retain these instructions for part numbers and for future reference.

| PART NUMBER | DESCRIPTION | QTY |
|--------------------|---|------------|
| 6234600 | Paper Mechanism Assembly | 1 |
| 6234608 | Cover - Spring | 2 |
| 6234616 | Screw - #10-32 x 3/8, T/C | 4 |
| 6234330 | Instructions - Installation | 1 |
| 6234614 | Spring - Shaft Compression | 2 |
| 6234601 | Ratchet Drive - Paper Mechanism | 1 |
| 6234622 | Paper Roll Assembly | 1 |
| 6154238 | Cover Assembly - Filter Paper Housing | 1 |
| 6204228 | Tape - Filter | 1 |
| 1451097 | Screw - #8-32 x .31, Hex Hd, T/F, Black | 2 |
| 6234297 | Basket - Paper Brewer | 1 |
| 6234329 | Assembly Bracket - Brewer | 1 |
| 9900167 | Screw - #8-32 x .88, RHS | 1 |
| 9900031 | Wingnut - #8-32 | 1 |

NOTE

Separate the figures from the text to make it easier to use the instructions.

INSTALLATION INSTRUCTIONS FOR PAPER MECHANISM KIT.

CAUTION

To prevent personnel injury, disconnect power from the merchandiser while performing these procedures.

Refer to Figure 1.

1. Take out the cup station.
2. Remove the two hoses from the brewer barrel manifold. Identify the hoses to aid reinstallation.

Refer to Figure 2.

3. Take the brewer assembly out of the merchandiser and remove the brewer barrel from the brewer barrel support.
4. Remove two 1/4-20 screws, springs, and 1/4-20 nuts from the brew barrel support and lift it off.
5. Lay the brewer on the side opposite the brewer drive connector. See Figure 4, sheet 1.

Refer to Figure 3, sheet 1.

6. Remove the two springs from the tabs on the bottom front wall assembly.
7. Using a small hammer and punch, drive out the swingarm shaft and remove the swingarm assembly.

Refer to Figure 3, sheet 2.

8. Manually put the brewer in the BREW position.
9. Mount the brewer assembly bracket (6234329) in the swingarm shaft mounting hole with the slots in the brewer assembly bracket capturing the pinion gear shaft and the brewer basket housing.
10. Secure in place with the screw (9900167) and wingnut (9900031).

Refer to Figure 4.

11. The brewer drive connector can be taken off by removing the retaining ring holding it in place. Note that the drive connector and the shaft can only be assembled one way.
12. Loosen and remove six screws retaining the brewer sidewall nearest you.
13. Lift off the sidewall, being careful to not disturb the alignment between the rack assembly, and the pinion gear assembly.
14. The paper mechanism ratchet drive (6234601) has two round locating pins and two square locating pins on one side. These pins mate with the holes and the pin slot in the cam on the cam and gear assembly. Orient the ratchet drive so these pins will engage the holes, and place it on the gear shaft and press down until the pins seat in the cam. See Figure 4, sheet 3, Detail A.
15. Install the shaft compression springs (6234614) into the slots on each side of the paper mechanism housing. The spring should press the shaft toward the open side of the paper mech. See Figure 4, sheet 3, Detail B.
16. With the paper guide facing up and toward the front of the brewer, install the paper mechanism into the paper mechanism mounting slot of the brewer sidewall. **Figure 5** shows the mounting position of the paper mechanism assembly in relation to the sidewall which was removed. Do not attempt to install the paper mechanism to this sidewall first!
17. Place the sidewall on the brewer while aligning the pinion gear shaft, gear and cam assembly shaft, roller linkage assembly, and the paper mechanism assembly with their respective holes and slots in the sidewall. These should line-up quite readily. If you experience difficulty, check the roller bearing on the basket housing. This roller, sometimes does not align with its' mating slot. See Figure 4, sheet 2.
18. Install the six screws in the sidewall and press the spring covers (6234608) over the paper mechanism endtabs. Use a flattip screwdriver to guide the endtabs into place. Install two screws (6234616) per spring cover to secure them to the sidewall. See Figure 4, sheet 1.

19. Remove the brewer assembly bracket (6234329). See Figure 3, sheet 2.
20. Manually put the brewer basket housing in the FLIP position as shown in Figure 4.
21. Replace the brewer basket that is in the brewer, with the new paper brewer basket (623497) furnished in the kit.
22. Install the drive connector. Put the retaining ring on the shaft.

Refer to Figure 3, sheet 1.

23. With the spring side facing down, put the swingarm assembly in the front of the brewer. Insert the swingarm shaft through the brewer sidewall, through the swingarm assembly retaining flanges and into the opposite sidewall. It may be necessary to use a small hammer or similar driving tool to tap on the end of the swingarm shaft in order to push it through.

24. Hook the ends of the springs hanging under the swingarm, to the tabs on the front of the brewer assembly.

Refer to Figure 4, sheet 1 and Figure 6.

25. Turn the brewer onto the bottom. Place the brewer barrel support, with the short flange to the front, on the brewer and secure the support with the two 1/4-20 screws, springs, and 1/4-20 nuts removed in step 4. Adjust the clearance between the top of the 1/4-20 nut and top of the slot in the sidewall to 5/8 IN.

Refer to Figure 2.

26. With the word REAR on the brewer barrel manifold facing the back of the brewer, line-up the flanges on the brewer barrel with the barrel support and install the brew barrel. Turn the brewer barrel 1/4 turn counterclockwise.

Refer to Figure 7.

27. Mount the filter paper roll mounting bracket (6234625) to the brewer drive mounting panel with two screws (1451097).

28. Attach the filter paper housing (6234630) to the filter paper roll mounting bracket with three screws (9900020) and three nuts (9900081).

29. Install the brewer to the brewer drive.

30. Attach the hoses you identified during removal in step 2, to the proper brewer barrel manifold opening.

31. See the Hot Drink Center Operator's Guide for filter paper loading instructions.

32. Restore power to the merchandiser.

33. Test the brewer and filter paper mechanism operation per the Hot Drink Center Operator's Guide.

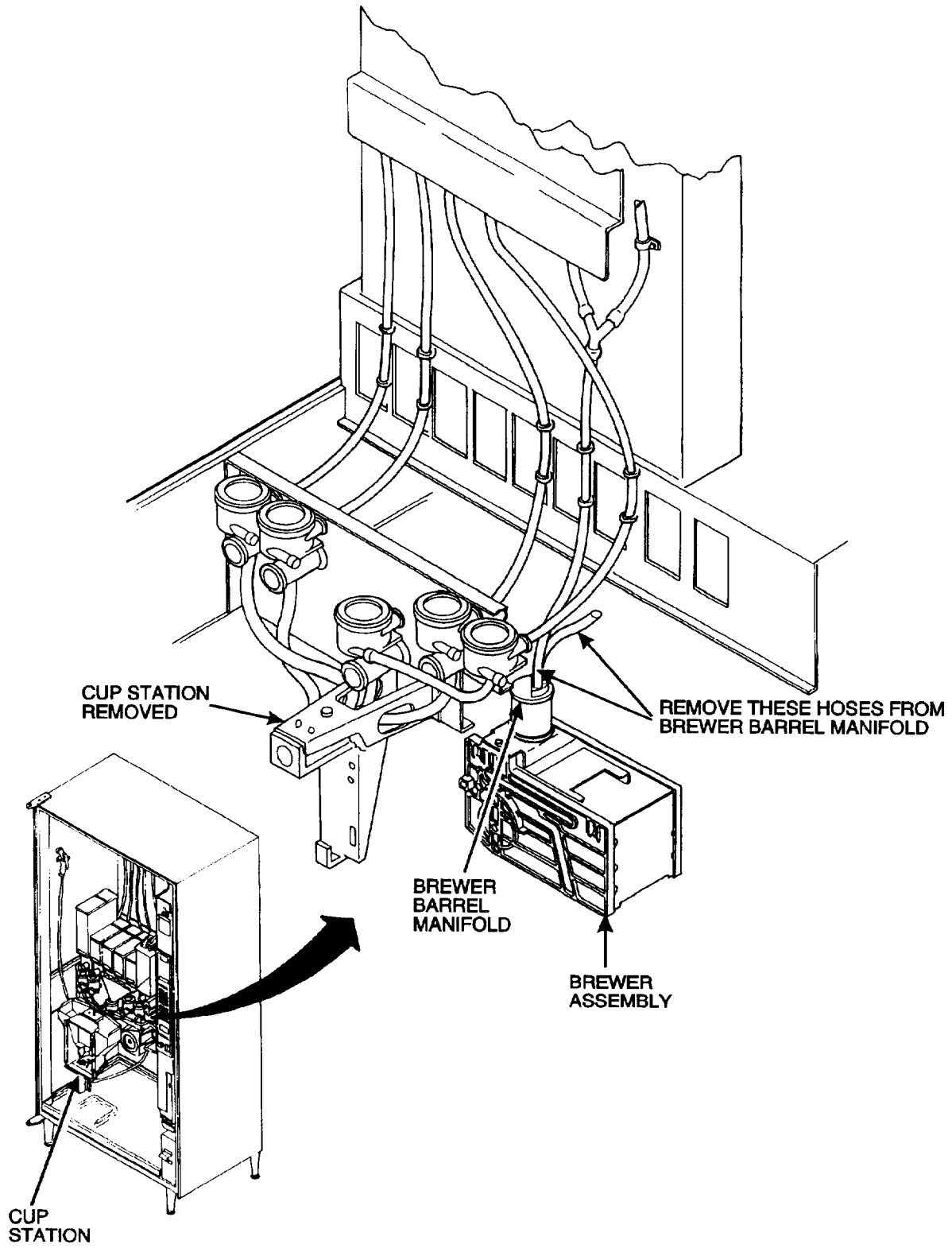

Figure 1.

623PK001

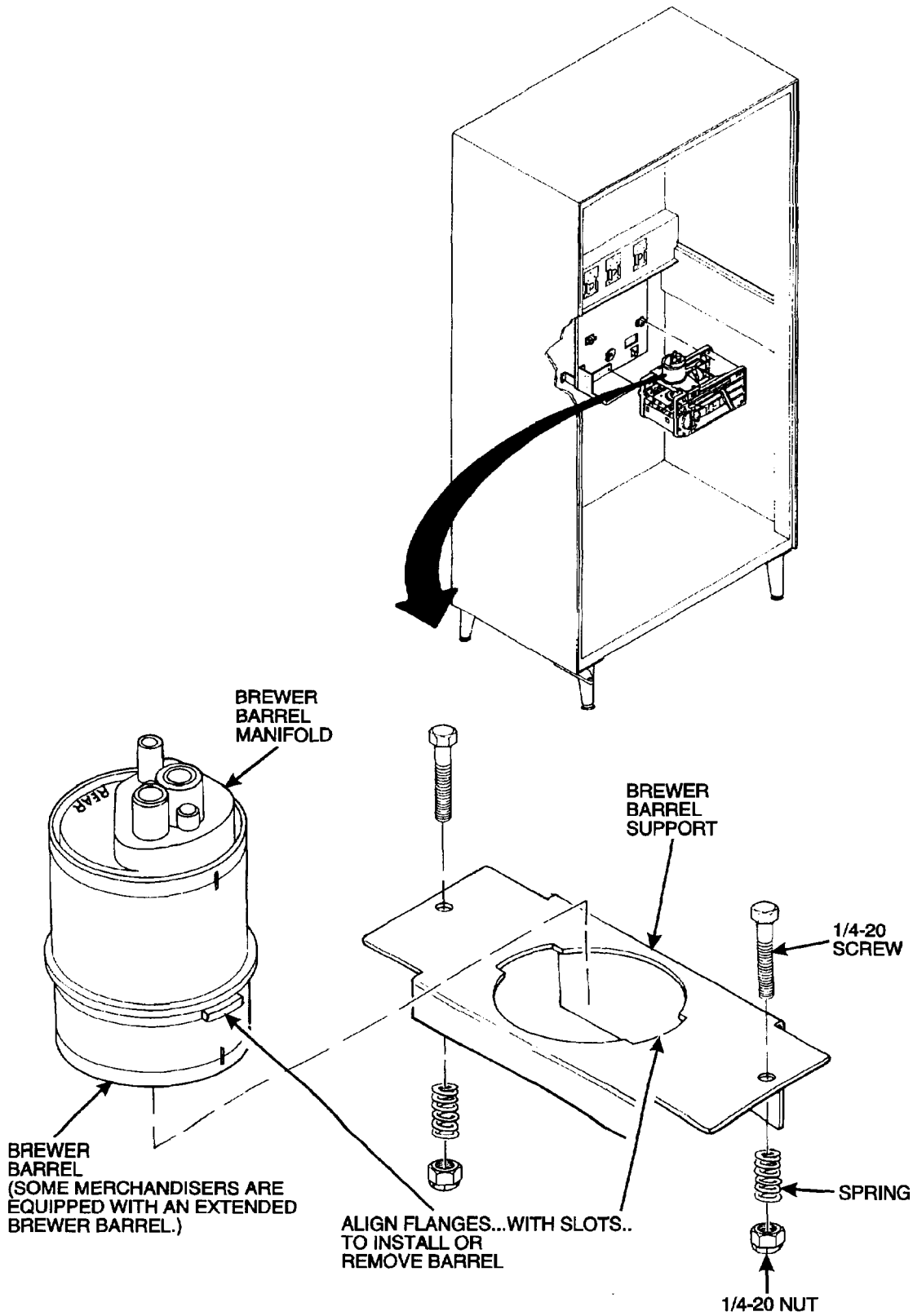

Figure 2.

623PK002

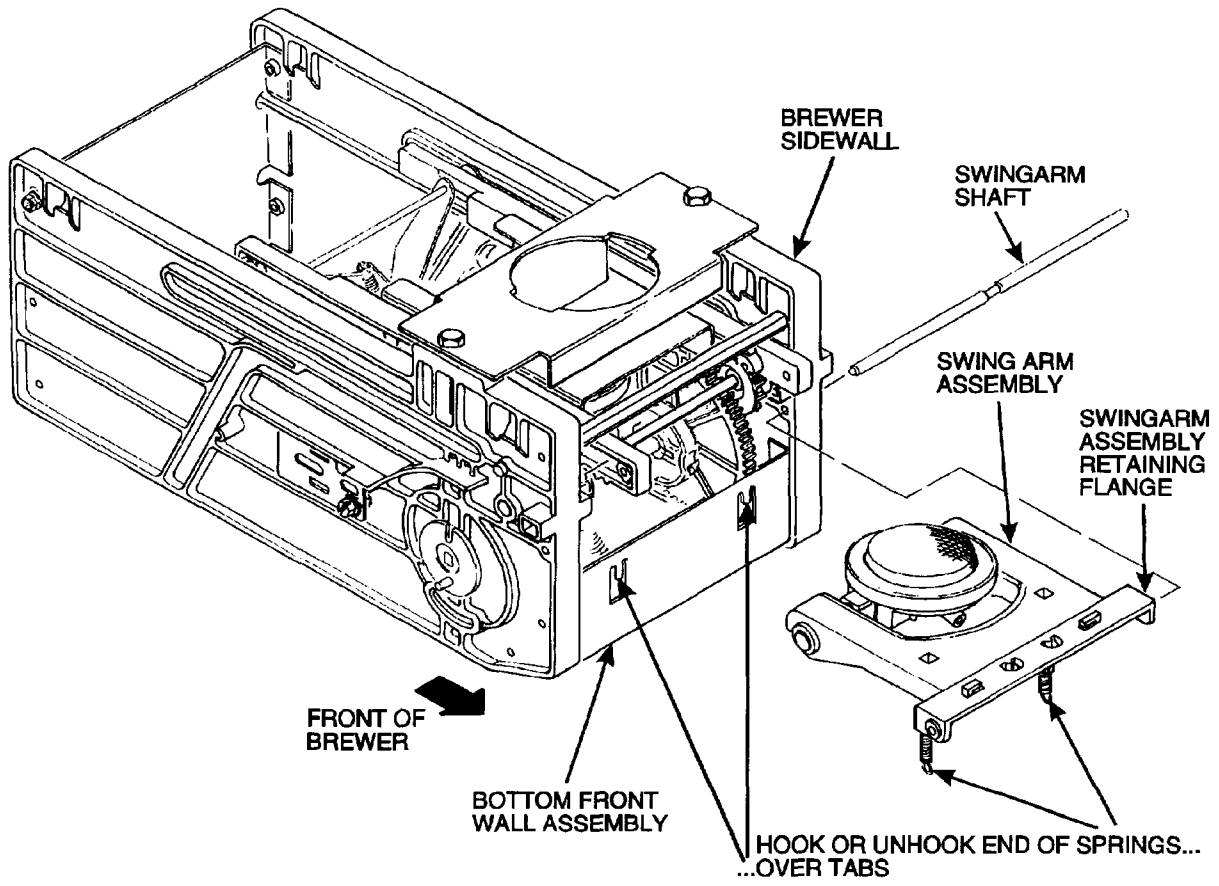

Figure 3. Sheet 1 of 2.

623PK012

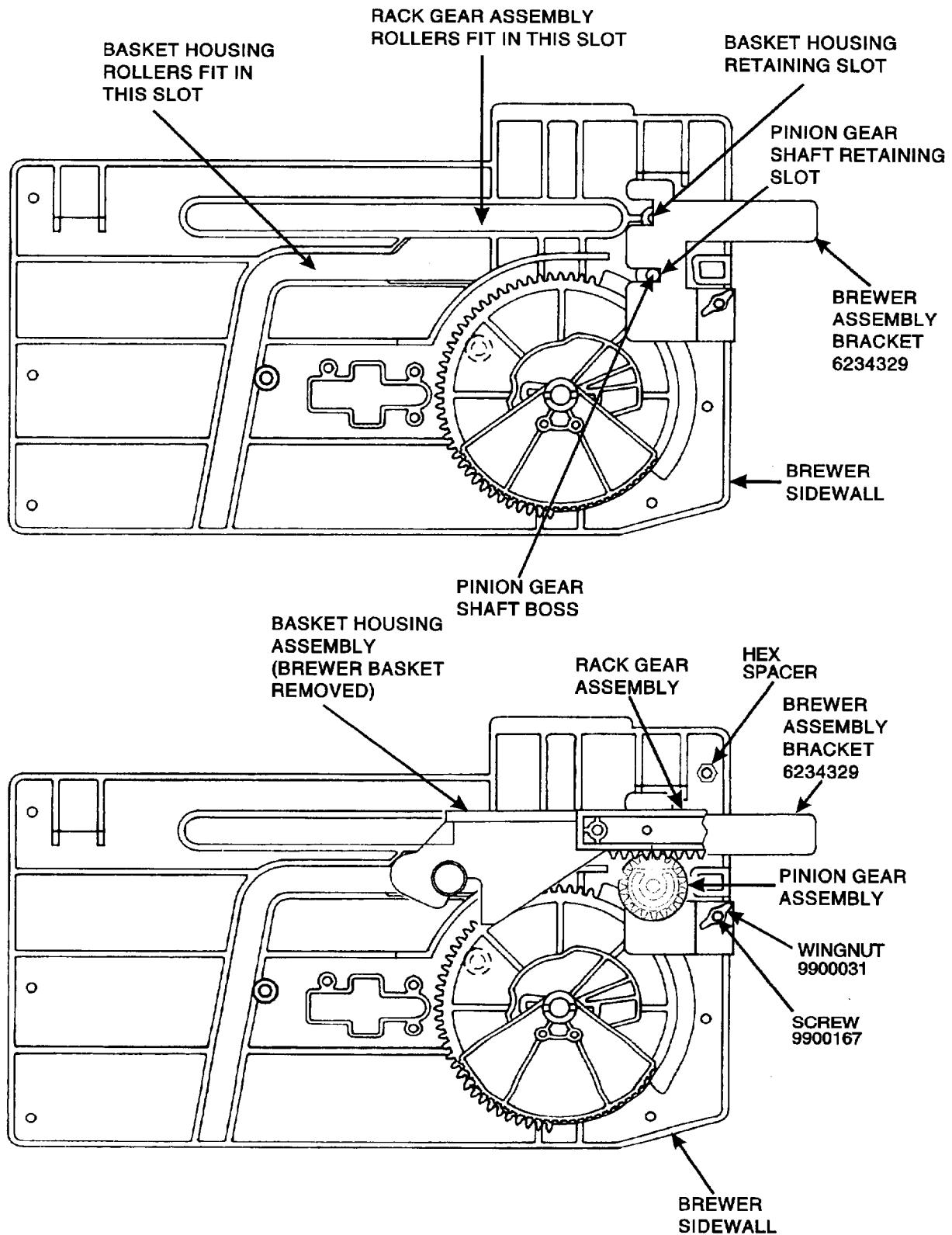
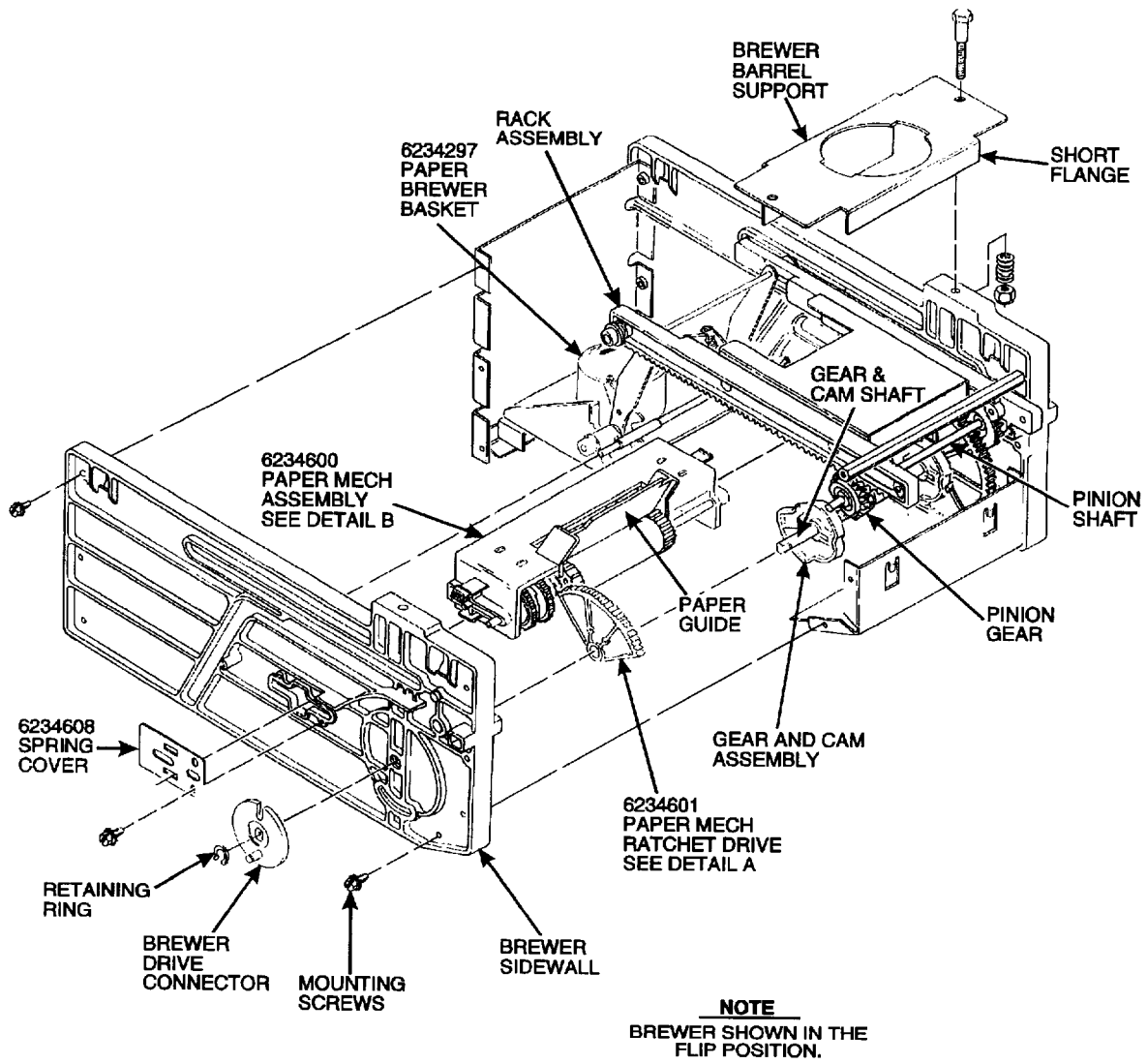

Figure 3. Sheet 2 of 2.

623PK011



623PK003

Figure 4. Sheet 1 of 3.

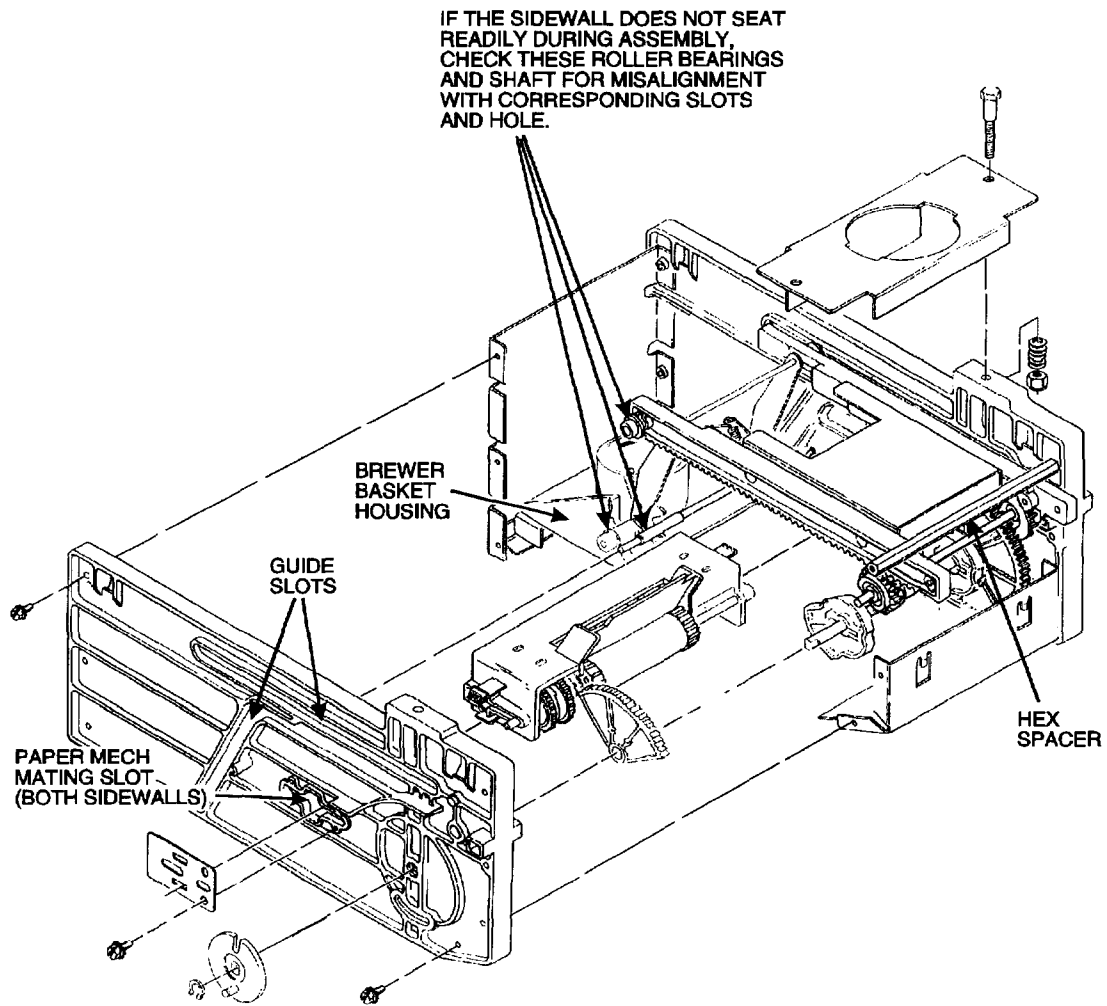

NOTE
BREWER SHOWN IN THE
FLIP POSITION.

623PK004

Figure 4. Sheet 2 of 3.

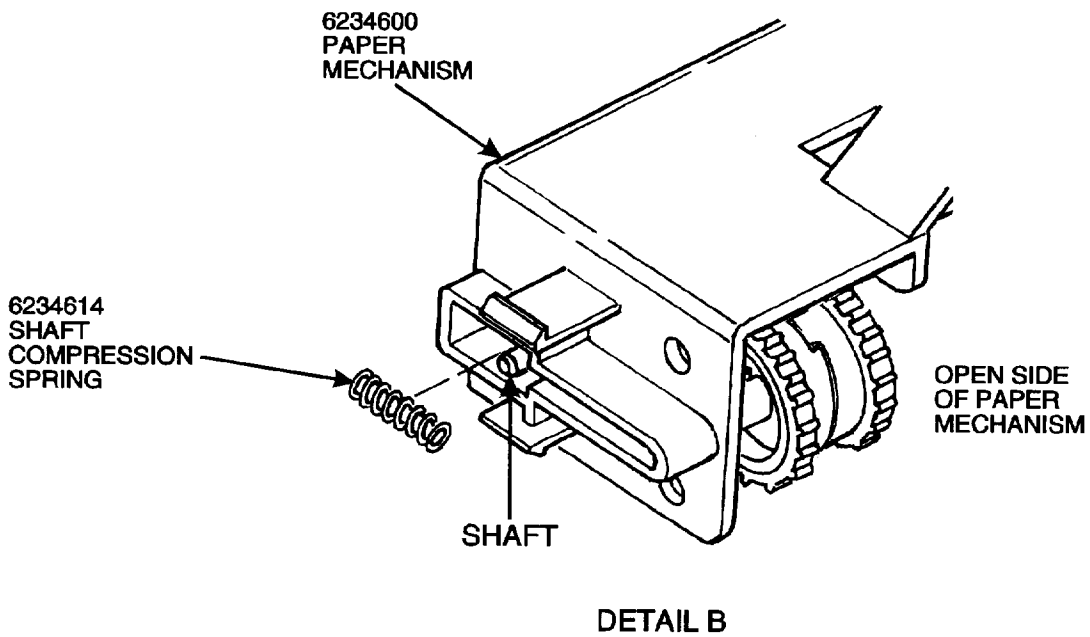
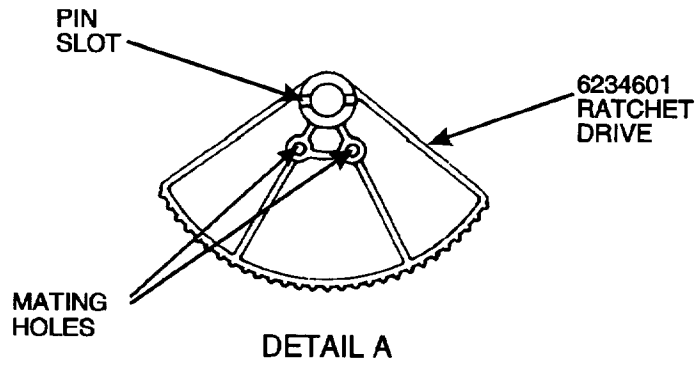

Figure 4. Sheet 3 of 3.

623PK005

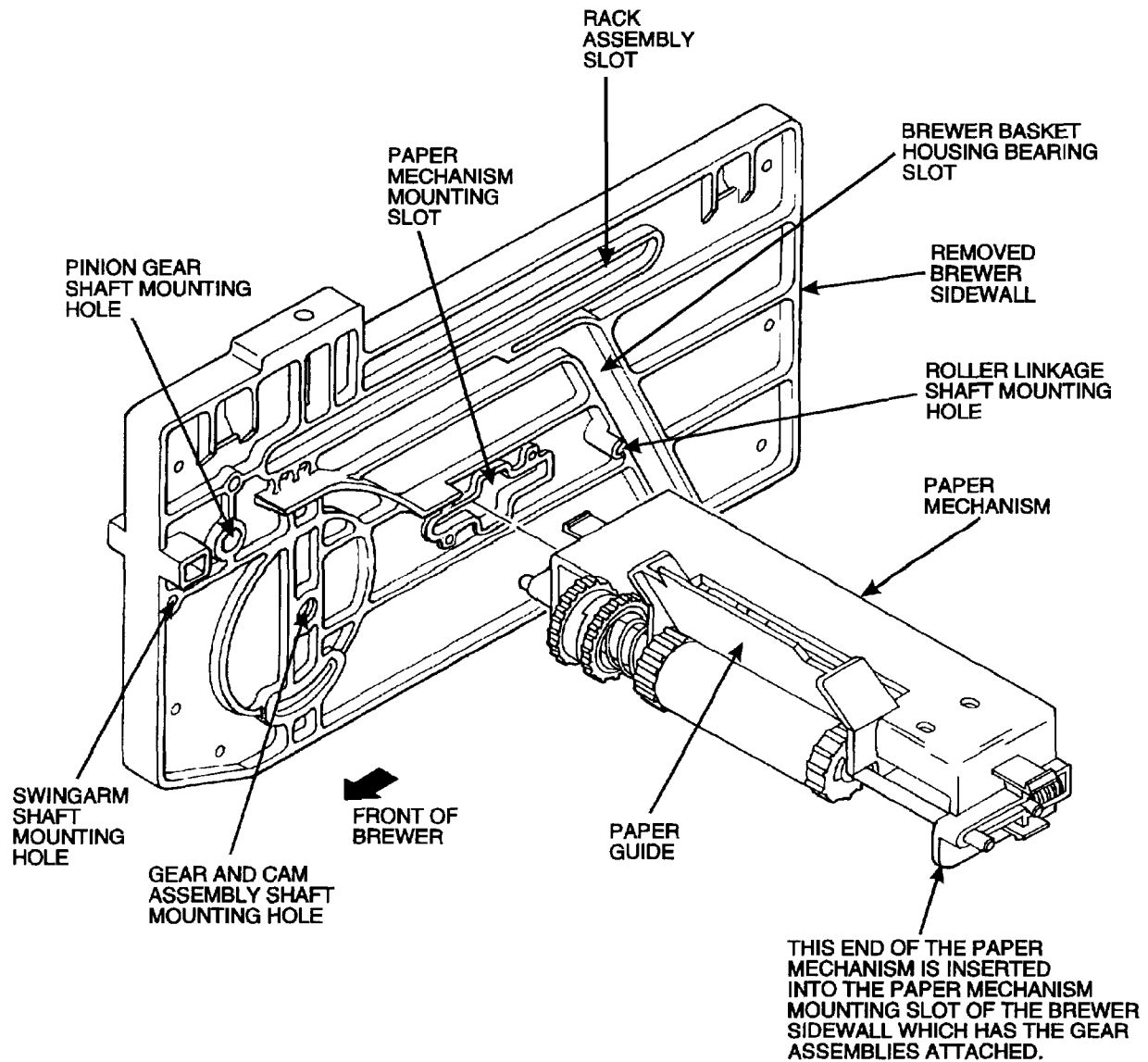

Figure 5.

623PK006

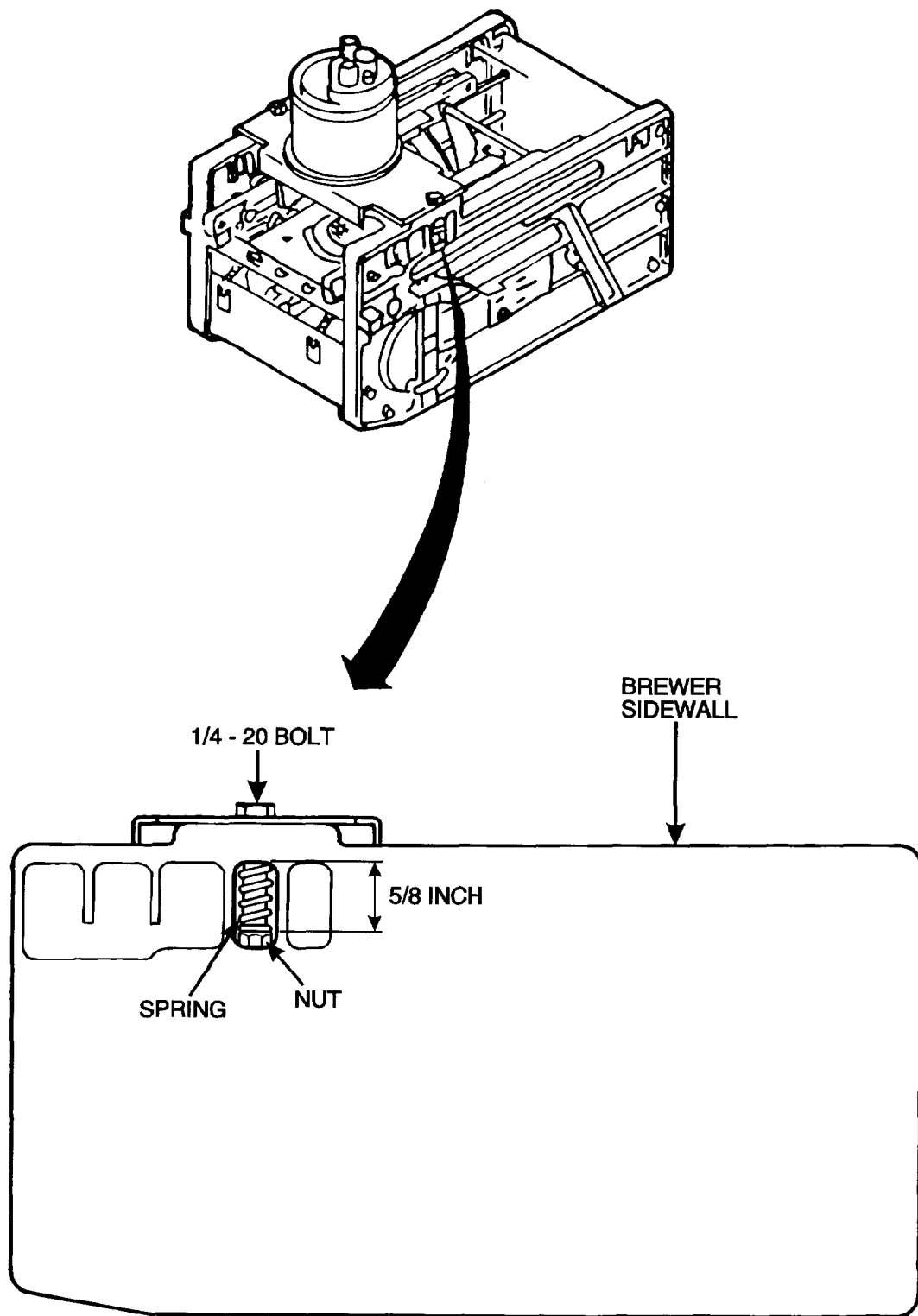

Figure 6.

623PK007

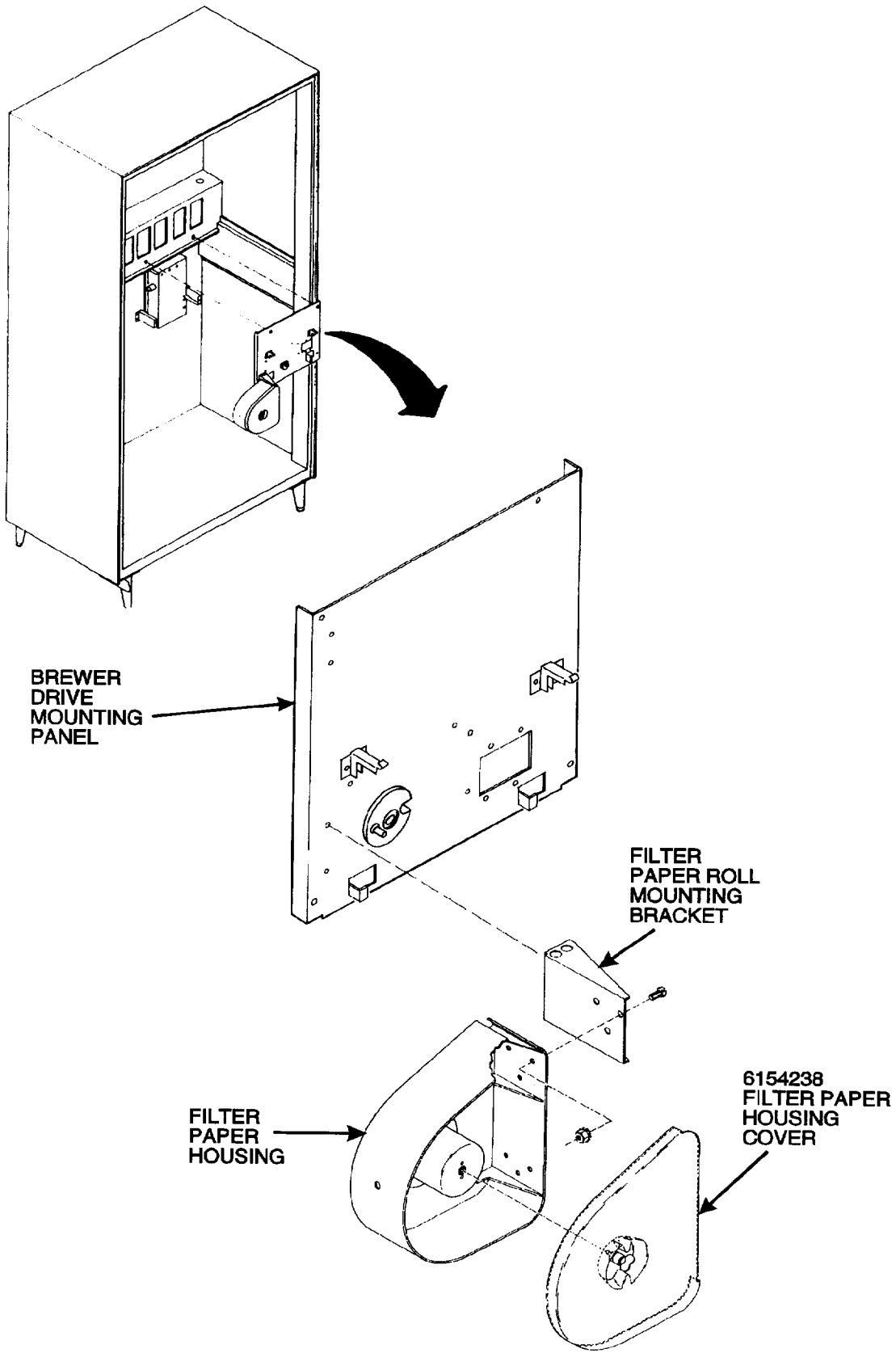

Figure 7.